

**To arrange a viewing contact us  
today on 01268 777400**

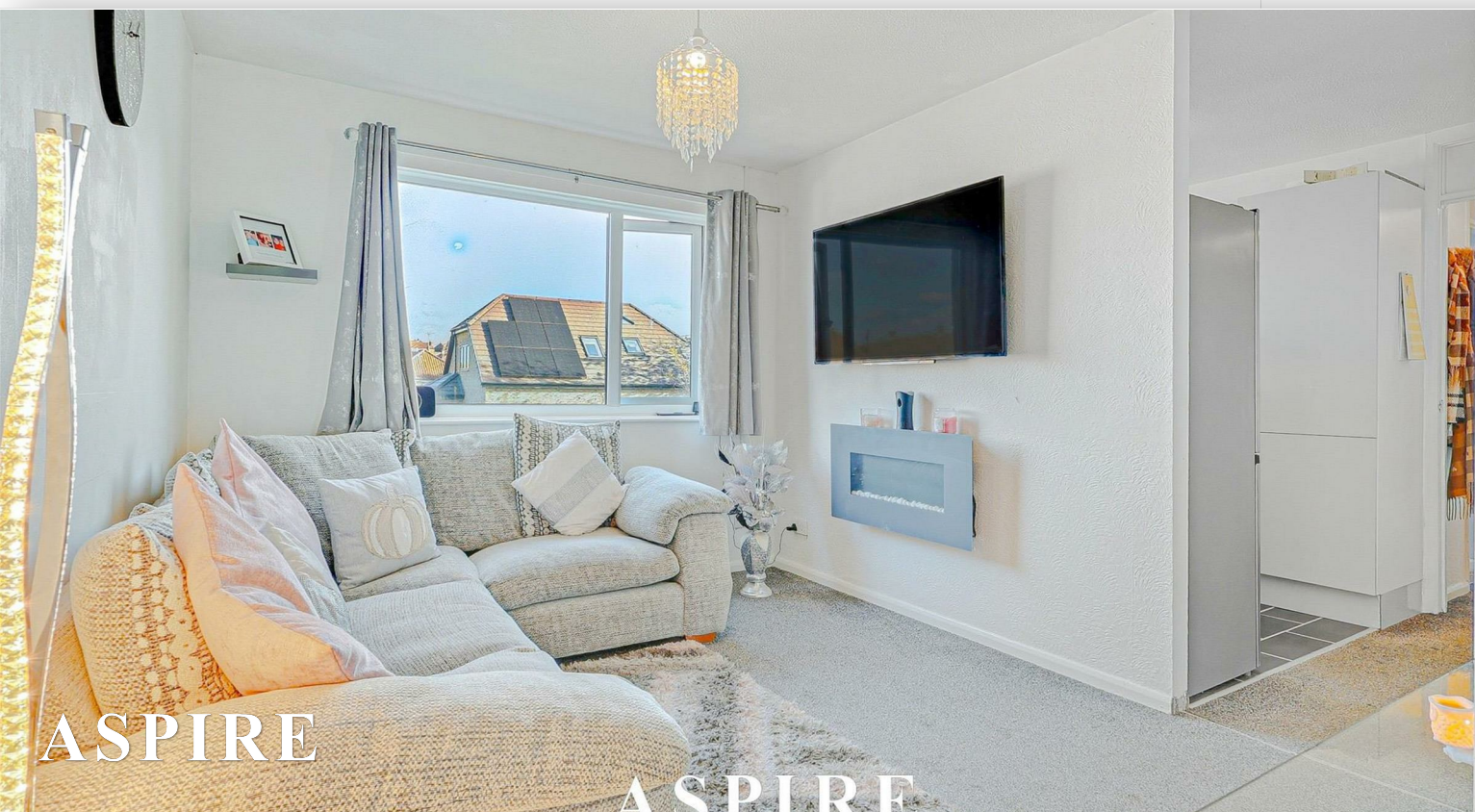

## **Rectory Road, Basildon £110,000**

Aspire Estate Agents Basildon are pleased to present this very well presented one-bedroom flat on Rectory Road, Pitsea, offered at 75% shared ownership and ideal for first-time buyers. The property features a secure intercom entry system, entrance hall, bright lounge, fitted kitchen, modern three-piece bathroom and a well-proportioned double bedroom with storage. Residents benefit from ample communal parking. Ideally located close to Pitsea town centre and train station.

Aspire Estate Agents Basildon presents this beautifully presented one-bedroom flat on Rectory Road, Pitsea, offers an ideal opportunity for first-time buyers looking to take their first step onto the property ladder. Available at 75% shared ownership, the property provides an affordable route into homeownership, with a monthly rent of just £100.62 on the remaining share. The flat is leasehold, with 83 years currently remaining, and benefits from a low annual ground rent of £35.00 and an annual service charge of £480.00. The freeholder is Basildon Council, and the property falls under Council Tax Band A, making it an economical choice for those seeking low running costs.

Accessed via a secure intercom entry system, the flat opens into a welcoming entrance hall. Inside, you will find a well-proportioned double bedroom with built-in storage, a modern three-piece bathroom, and a bright, comfortable lounge perfect for relaxing. The kitchen offers functional workspace with fitted units, an electric hob and oven to remain, and space for additional appliances.

Residents enjoy ample communal parking along with well-maintained communal garden areas, providing pleasant outdoor space to unwind.

Ideally located close to Pitsea town centre, the property offers convenient access to shops, cafés, and everyday amenities. Pitsea train station is also within easy reach, ensuring excellent transport links for commuters.

This delightful flat represents a fantastic opportunity for anyone seeking a well-presented, low-maintenance home in a thriving location. Aspire Estate Agents Basildon highly recommend an internal viewing to fully appreciate all that this property has to offer.

Enter the property via secure intercom entry.

Lounge 14'0 x 8'10.

Kitchen 9'1 x 6'9.

Bathroom.

Double bedroom 10'9 x 8'11.

GROUND FLOOR  
1068 sq.ft. (99.2 sq.m.) approx.

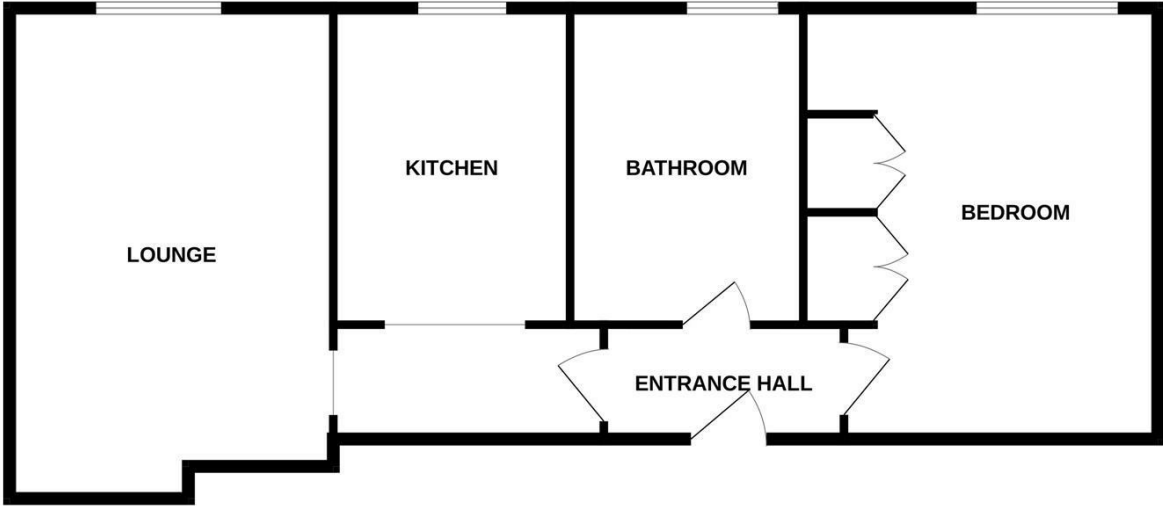

TOTAL FLOOR AREA : 1068 sq.ft. (99.2 sq.m.) approx.  
Whilst every attempt has been made to ensure the accuracy of the floorplan contained here, measurements of doors, windows, rooms and any other items are approximate and no responsibility is taken for any error, omission or mis-statement. This plan is for illustrative purposes only and should be used as such by any prospective purchaser. The services, systems and appliances shown have not been tested and no guarantee as to their operability or efficiency can be given.  
Made with Metropix ©2025

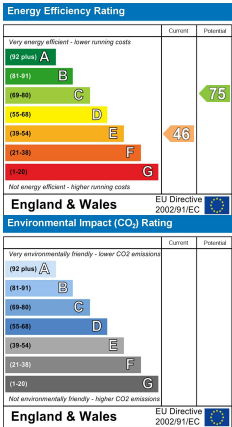

rightmove.co.uk  
The UK's number one property website

Zoopla.co.uk

Under the Property Misdescriptions Act 1991 we make every effort to ensure our sales details are accurate but they are a general outline and do not constitute any part of an offer or contract. Any services, equipment and fittings have not been tested and no warranty can be given as to their condition. We strongly recommend that all the information provided be verified by your advisors and in particular, measurements required for a specific purpose such as fitted furniture or carpets. Please tell us if you have any problems and members of our branches will help either over the phone or in person. A copy of our complaints procedure is available on request. The details are issued on the strict understanding that any negotiations in respect of the property named herein are conducted through Aspire Estate Agents.